



DUALEX BUILDS

TRANSIT CONNECT SLIDE OUT KITCHEN BUILD PLAN



KITCHEN DIMENSIONS

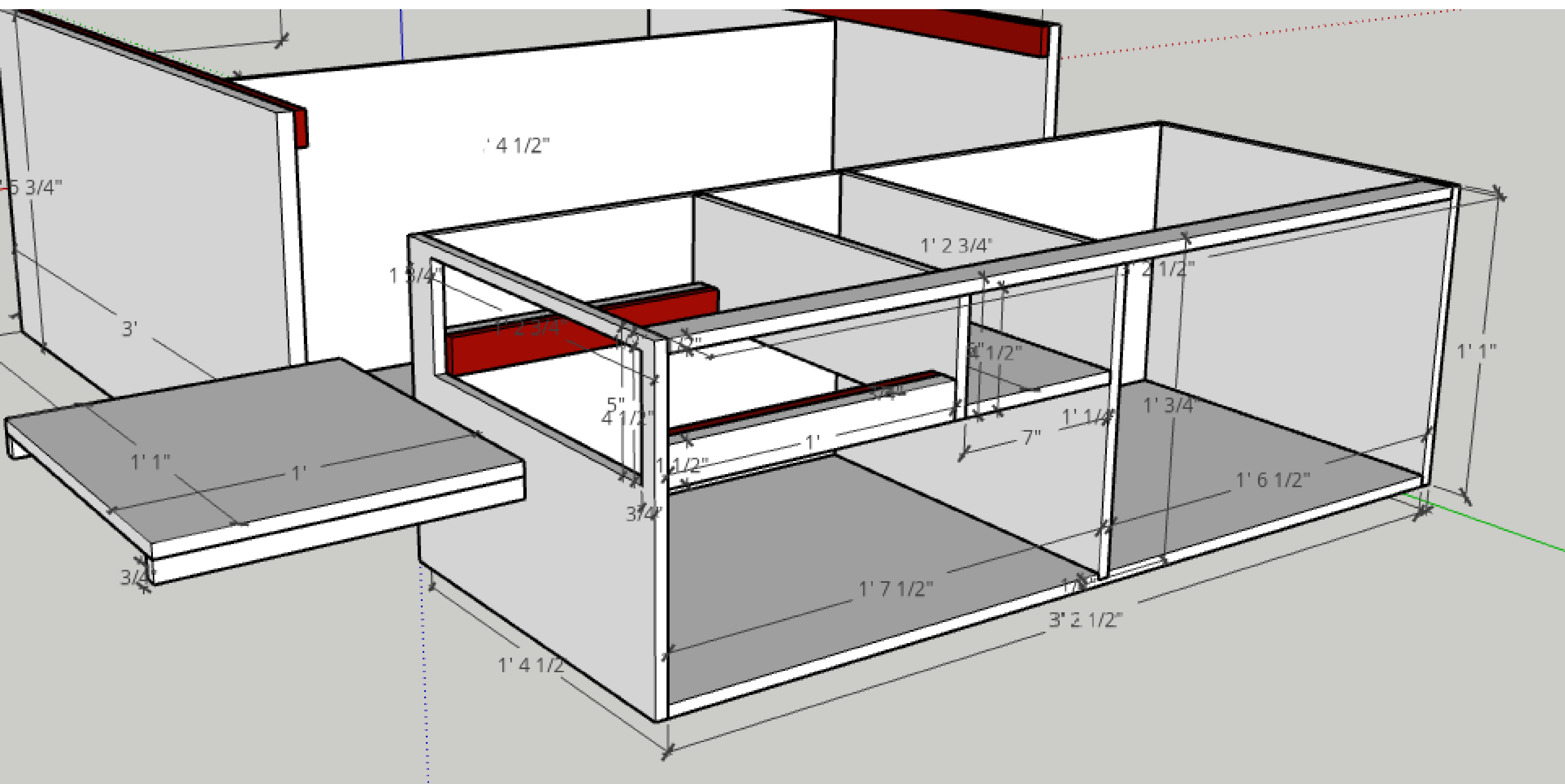

This build may seem complicated, but you're basically building a box with walls to separate compartments.

The walls of this cabinet box are made from 1/2" Plywood. The supports for the cooktop drawer are made from 3/4" material.

KITCHEN DRAWER

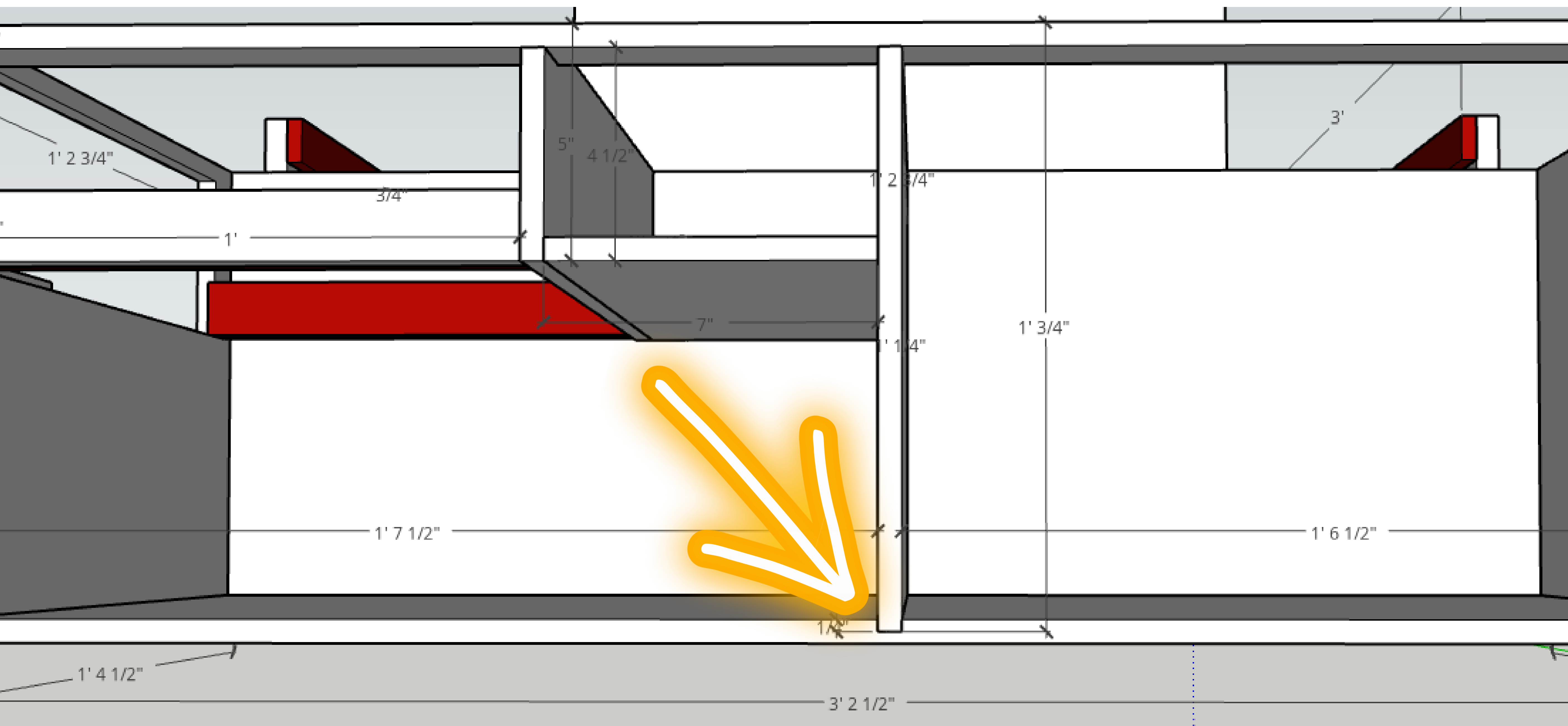

The 3d model shows a slot in the bottom and back wall of the cabinet. I cut these slots with my table saw to allow for a snug fit and strong joinery of the cabinet. If you choose to build the cabinet without cutting the slots, you will need to change the dimensions of the vertical support wall in the center to reflect that.

MAKING CHANGES

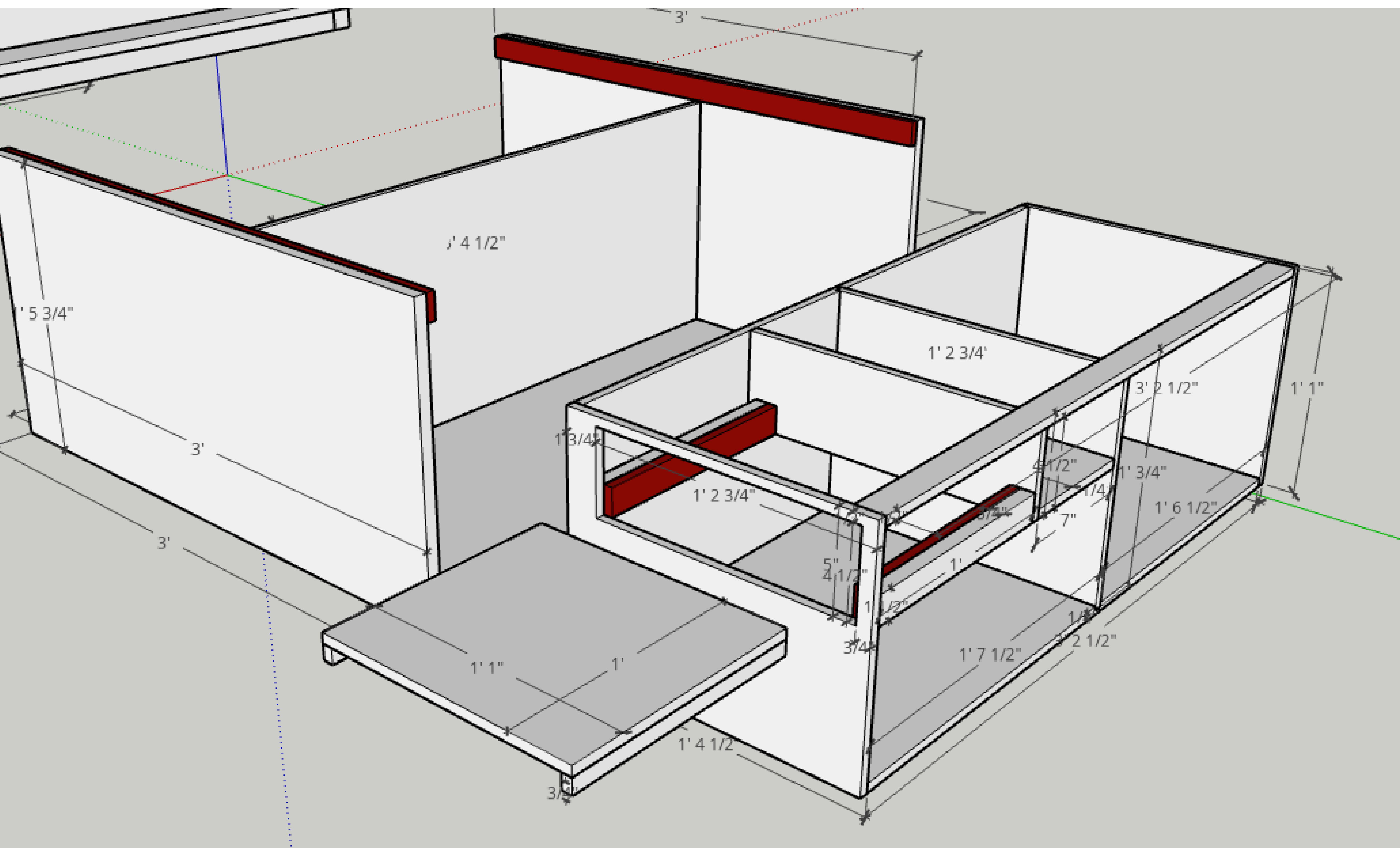

This cabinet was designed to fit inside of the bed frame of my camper that was previously built. You may need to change the overall dimensions to make this design work for you.

Good luck on your build!